

6.21 Convection Heater Removal and Replacement



Safety:

When working on the unit, make sure that the main power supply is disconnected (An all-pole isolation switch with a minimum contact opening of 3mm must be located close to the unit – on site) and ensured against switching on again.



Instruction – Removing the Convection Heater:

- Remove heating terminals from the crimp connections.
- Remove suction panel from oven.
- (When fitted) Dismantle the probe holder in the area of the fan wheel by removing the 2 hexagon nuts M 4.
- Remove fan wheel (see Service Instructions 6.8).
- Remove the fastenings for the heating element in the electrical connections area (hexagon nut M 14x1.5 –pipe spanner diameter 19mm).
- Remove the fastenings for the heating element in the oven area (hexagon nut M 4).
- Remove heating element.



Instructions – Replacing the convection heater:

- Line up the new heating element, when necessary.
- Bring the new heater with the heat conducting fastenings into the previous position and fasten in oven area with the hexagon nut M 4 and washers.
- Fasten in the electrical connection area with the hexagon nuts M 14 x 1.5 and pipe wrench 19 mm.
- When assembling the heating element make sure that the coils are evenly spaced from each other.
- When screwing on the hexagon nuts (M 14 x 1,5) in the oven area, use an adjustable wrench of 19mm on the other side of the wall for support.
- After installing, check the spacing between the fan wheel and the heating element (→ 6.8).
- The element should be positioned with an even distance to all points on the fan wheel.
- Refasten heating terminals to the crimp connections and make sure the cable connections are correct (star or triangle).



Special tools:

- Pipe spanner 19 mm
- Adjustable wrench 19 mm

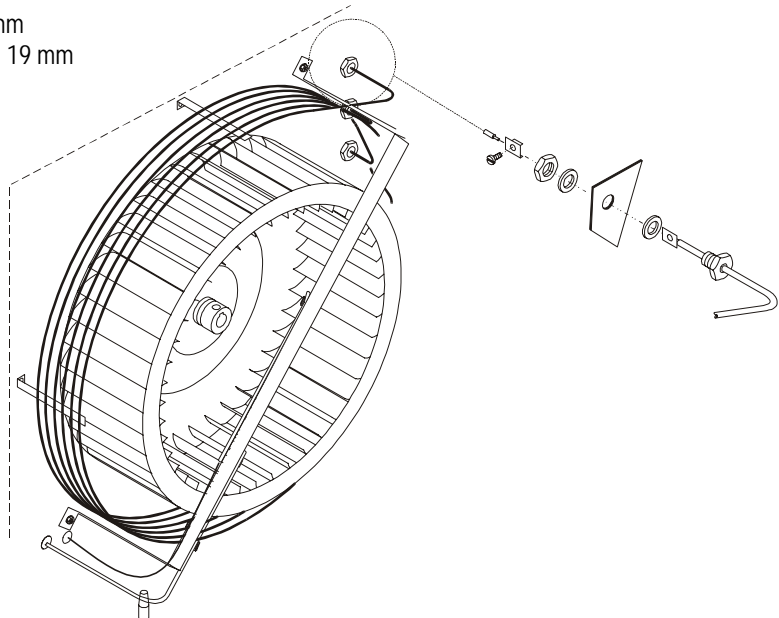

Cross reference:

- Service Handbook 6.8 Motor Removal and Installation